

PROPOSED LAND CEILING PLAN OF G+1 STORIED RESIDENTIAL BUILDINGS AT MOUZA- NOWBAD,J.L. NO- 19,R.S. DAG NO. 375(P),376(P) ,P.S.- BISHNUPUR ,P.O.- RASAPUNJA, UNDER RASAPUNJA GRAM PANCHAYAT SAMITI,DIST-SOUTH 24 PARGANAS, WEST BENGAL.

LATITUDE : 22°25' NORTH
LONGITUDE : 88°16' EAST

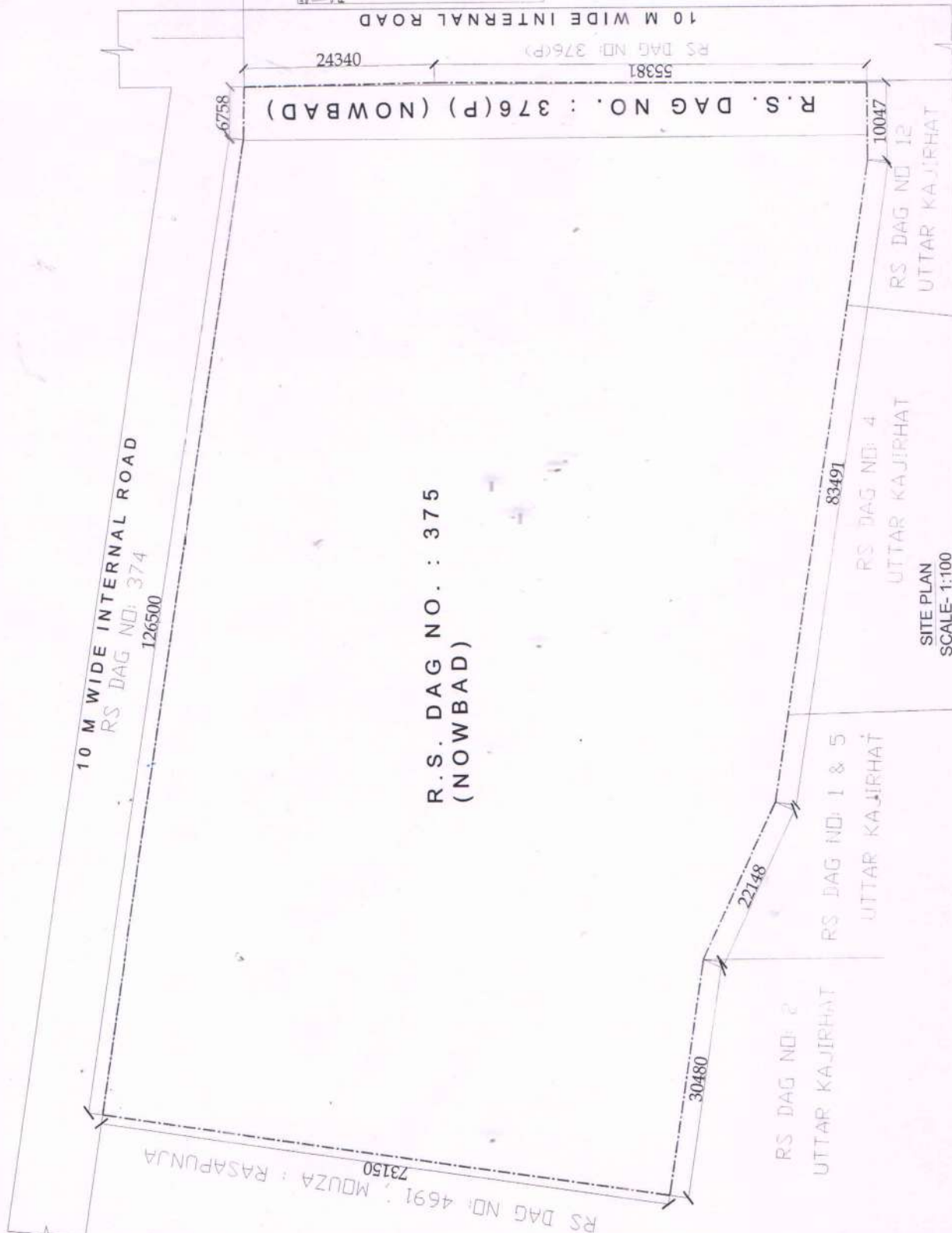

LOCATION PLAN

PROJECT: TOPAZ (GEMS CITY.)

SIGNATURE OF THE ARCHITECT

[Signature]

Tirupati Carrier Ltd.

Director

[Signature]

SIGNATURE OF THE AUTHORIZED SIGNATORY (S)

TITLE: BOUNDARY PLAN & KEY PLAN OF TOPAZ